

## Threaded Lift Pin

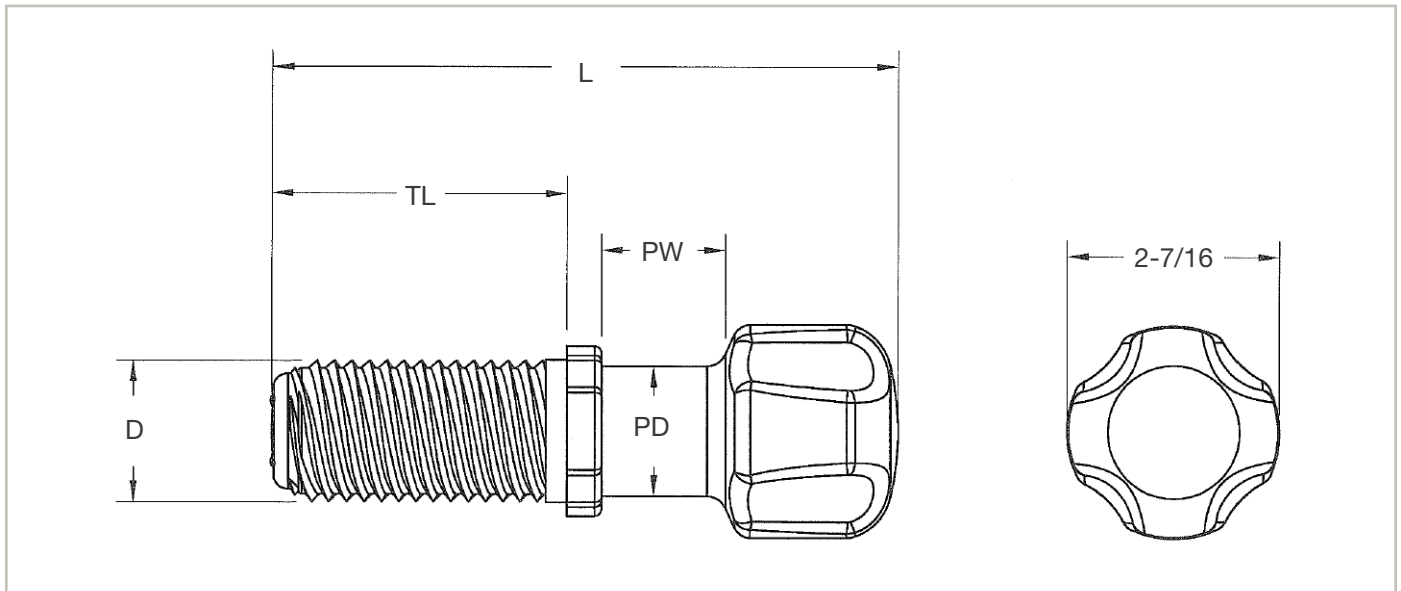

Threaded Lift Pin Dimensions						
Item Number	L (in)	D (in)	TL (in)	PW (in)	PD (in)	Weight (lbs)
BC120050	7.18	1.61	3.38	1.43	1.48	1.72

Lift Pin Load Chart				
Item Number	Min Concrete Thickness	Allowable Shear Load SF 4:1 (lbs)	Ultimate Mechanical Shear Load (lbs)	Min Edge Distance (in)
BC120050	5	4,000	20,000	12

Table is based on dead load in shear only, 150PCF, a standard concrete compressive strength of 3,500 psi, and manhole fabrication and reinforcement in accordance with ASTM C497.

Meadow Burke has done exhaustive testing in the field and with an independent lab. We've validated the actual/true safe working load of our product to be 4,000 lbs per lifter, with a 4:1 safety factor. A lifting device is only as good as the concrete around it, and knowing the "true" safe working load keeps you and your team safe. The product can be handled with spreader bar and chains, hooks or slings.

### Composition:

- Injection molded with durable polypropylene conforming to ASTM D-4101
- 1 diameter Grade 60 reinforcing bar conforming to ASTM A-615

