

# Engineering Work Order

## Rapid Lok

Date:

MB Salesman:

Contractor/Precaster:

Project Name:

Job City:

Eng of Record:

Phone:

Project Number:

State:

### 1. RAPID LOK TYPE

#### Rapid Lok Ultimate

Rapid Lok Ultimate-8" – 3 HR Fire Rating

Rapid Lok Ultimate-10" – 3 HR Fire Rating

#### Steel Angle

6 KIP 4"-3 HR Fire Rating

15 KIP 4"-1 HR Fire Rating

20 KIP 6"-1 HR Fire Rating

20 KIP 8"-1 HR Fire Rating

30 KIP 8"-2 HR Fire Rating

30 KIP Thin Wall-2 HR Fire Rating

40 KIP 8½"-1 HR Fire Rating

#### Steel Corbel

20 KIP 7⅞"-1 HR Fire Rating

20 KIP 7⅞"-2 HR Fire Rating

30 KIP 7⅞"-1 HR Fire Rating

30 KIP 7⅞"-2 HR Fire Rating

40 KIP 7⅞"-1 HR Fire Rating

40 KIP 7⅞"-2 HR Fire Rating

#### Concrete Corbel

20 KIP 6"-2 HR Fire Rating

20 KIP 8"-2 HR Fire Rating

30 KIP 8"-2 HR Fire Rating

30 KIP 8" Thin Wall-2 HR Fire Rating

40 KIP 8½"-2 HR Fire Rating

### 2. EDGE DISTANCE - Distance from Edge of Concrete to Edge of RL Embed Plate

C1:

C2:

C3:

C4:

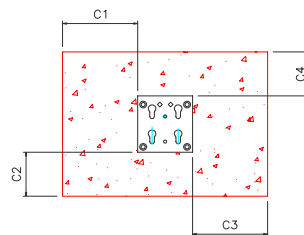

### 3. CONCRETE INFORMATION

Concrete Strength:                      psi

Concrete Thickness:                      in.

Concrete Weight:  150 pcf     150 pcf

Other, specify:                      pcf

### 4. UNFACTORED LOAD INFORMATION

Applied Shear Live:                      kips

Applied Shear Dead:                      kips

Applied Shear Roof Live:                      kips

Applied Shear Snow:                      kips

Out of Plane Shear Eccentricity:                      in.

In Plane Shear Eccentricity:                      in.

Home of: **MLB** MeadowBurke